

Automatic Water Column Drain Kit for FireLock NXT™



SEE VICTAULIC PUBLICATION 10.01 FOR DETAILS

VALVES SERIES 75D

The Series 75D water column pretrimmed kit can be easily retrofitted to Victaulic FireLock NXT devices. Used on FireLock NXT Series 768 Dry, 769 Deluge or Preaction Devices (and Series 756 Dry and Series 758 Preaction devices) to minimize residual water in the riser from collecting above the clapper, preventing failures under adverse conditions such as freezing temperature. The kit will automatically drain the water without affecting system pressure. Rated to 175 psi (1205 kPa), the Series 75D will also work in conjunction with integral anti-flooding devices and the FireLock Series 748 Ball Check valve to keep air supplies from being flooded in the actuator and compressor systems. The Series 75D kit is unique because no operator maintenance or resetting is required.



MATERIAL SPECIFICATIONS

Housing: Ductile Iron

Inner Components: 304 stainless steel

Trim Nipples: Galvanized

Fittings: Galvanized

Seal: Nitrile

Accessories:

- Brass Connector
- Plastic Drain Hose

Strainer: Brass with stainless steel mesh

JOB/OWNER

System No. _____

Location _____

CONTRACTOR

Submitted By _____

Date _____

ENGINEER

Spec Sect _____ Para _____

Approved _____

Date _____

Automatic Water Column Drain Kit for FireLock NXT™

VALVES SERIES 75D

COMPONENTS

A close nipple (1/2-inch NPT x 1.13) and a ball valve (not supplied with kit) are required, as shown, when the Series 75D is installed on a Series 764 FireLock NXT Alternate Wet/Dry Valve

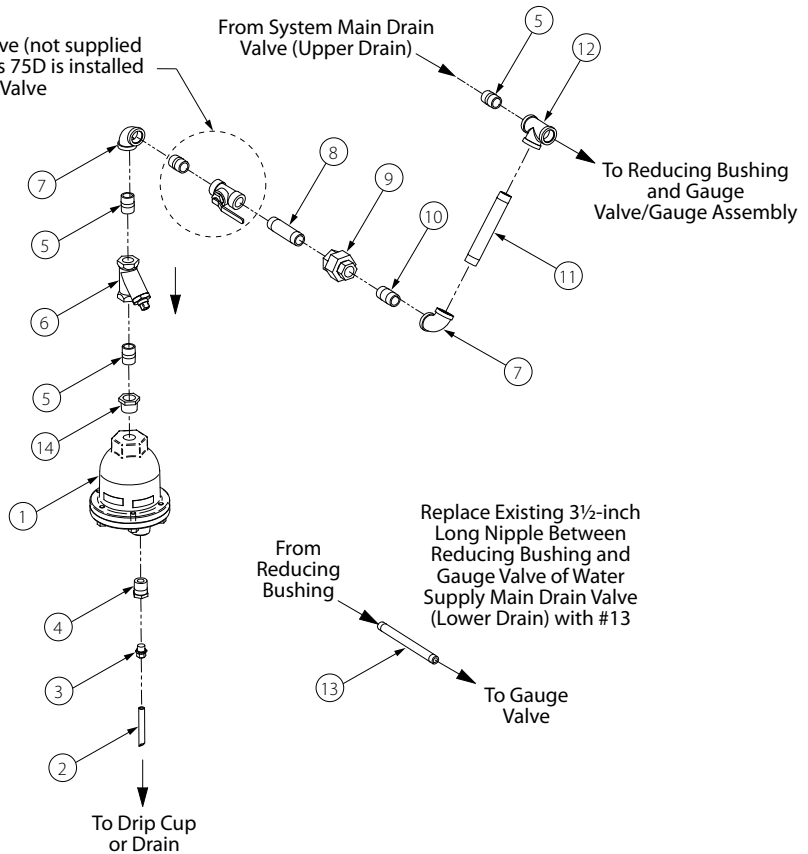

1 1/2 – 2 inch/48.3 – 60.3 mm Series 75D Trim Assemblies

Bill of Materials

Item	Qty.	Description
1	1	Series 75D Automatic Water Column Drain
2	1	Clear Tubing
3	1	Compression Fitting
4	1	Reducing Bushing (1/2-inch NPT x 1/4-inch NPT)
5	3	Close Nipple (1/2-inch NPT x 1.13)
6	1	Strainer (100 Mesh)
7	2	90° Female Elbow (1/2-inch NPT)
8	1	Nipple (1/2-inch NPT x 3.00)
9	1	Union (1/2-inch NPT)
10	2	Nipple (1/2-inch NPT x 1.50)
11	1	Nipple (1/2-inch NPT x 5.00)
12	1	Female Tee (1/2-inch NPT)
13	1	Nipple (1/4-inch NPT x 6.00)
14	1	Reducing Bushing (3/4-inch NPT x 1/2-inch NPT)

Automatic Water Column Drain Kit for FireLock NXT™

VALVES SERIES 75D

COMPONENTS

A close nipple (½-inch NPT x 1.13) and a ball valve (not supplied with kit) are required, as shown, when the Series 75D is installed on a Series 764 FireLock NXT Alternate Wet/Dry Valve

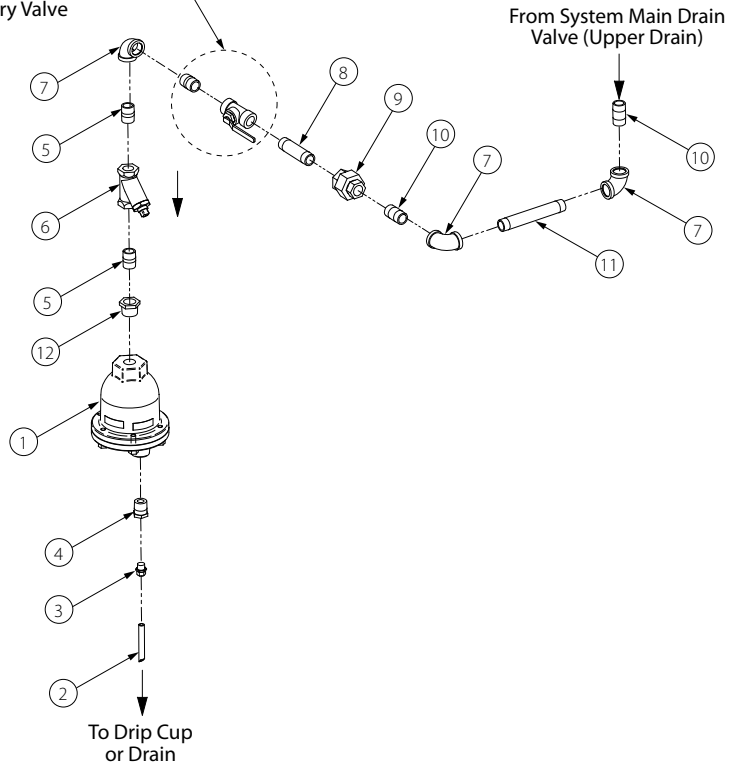

2½ – 8 inch/73.0 – 219.1 mm Series 75D Trim Assemblies

Bill of Materials

Item	Qty.	Description
1	1	Series 75D Automatic Water Column Drain
2	1	Clear Tubing
3	1	Compression Fitting
4	1	Reducing Bushing (½-inch NPT x ¼-inch NPT)
5	3	Close Nipple (½-inch NPT x 1.13)
6	1	Strainer (100 Mesh)
7	3	90° Female Elbow (½-inch NPT)
8	1	Nipple (½-inch NPT x 3.00)
9	1	Union (½-inch NPT)
10	2	Nipple (½-inch NPT x 1.50)
11	1	Nipple (½-inch NPT x 5.00)
12	1	Reducing Bushing (¾-inch NPT x ½-inch NPT)

Automatic Water Column Drain Kit for FireLock NXT™

VALVES SERIES 75D

WARRANTY

Refer to the Warranty section of the current Price List or contact Victaulic for details.

NOTE

This product shall be manufactured by Victaulic or to Victaulic specifications. All products to be installed in accordance with current Victaulic installation/assembly instructions. Victaulic reserves the right to change product specifications, designs and standard equipment without notice and without incurring obligations.

For complete contact information, visit www.victaulic.com

30.34 3235 REV C UPDATED 03/2011

VICTAULIC IS A REGISTERED TRADEMARK OF VICTAULIC COMPANY. © 2011 VICTAULIC COMPANY. ALL RIGHTS RESERVED.

30.34

