







# FireLock® Dry Accelerator

SERIES 746-LPA

**MATERIAL SPECIFICATIONS**

**Body:** Bronze per CDA-836 (85-5-5-5)

**Diaphragm:** EPDM

**Seal:** EPDM

**Spring:** Type 316 Stainless Steel

**Restrictor:** Porous Stainless Steel

**Bolts:** Type 316 Stainless Steel

**O-ring:** EPDM

**Bill of Materials**

- |   |                     |    |                       |
|---|---------------------|----|-----------------------|
| 1 | Opening/Air Chamber | 9  | O-Ring                |
| 2 | Restrictor          | 10 | Seal Support          |
| 3 | Piston              | 11 | Closing Chamber Seal  |
| 4 | O-Ring              | 12 | Button-Head Cap Screw |
| 5 | Diaphragm           | 13 | Washer                |
| 6 | Actuator Shaft      | 14 | Adjustable Seat       |
| 7 | Closing Chamber     | 15 | Check Valve           |
| 8 | Compression Spring  |    |                       |

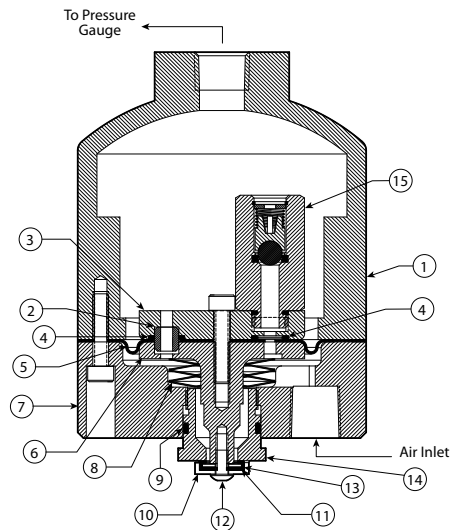

**WARRANTY**

Refer to the Warranty section of the current Price List or contact Victaulic for details.

**NOTE**

This product shall be manufactured by Victaulic or to Victaulic specifications. All products to be installed in accordance with current Victaulic installation/assembly instructions. Victaulic reserves the right to change product specifications, designs and standard equipment without notice and without incurring obligations.



For complete contact information, visit [www.victaulic.com](http://www.victaulic.com)

30.64 2934 REV G UPDATED 1/2009

VICTAULIC IS A REGISTERED TRADEMARK OF VICTAULIC COMPANY. © 2009 VICTAULIC COMPANY. ALL RIGHTS RESERVED.

